

Choctawhatchee Bay

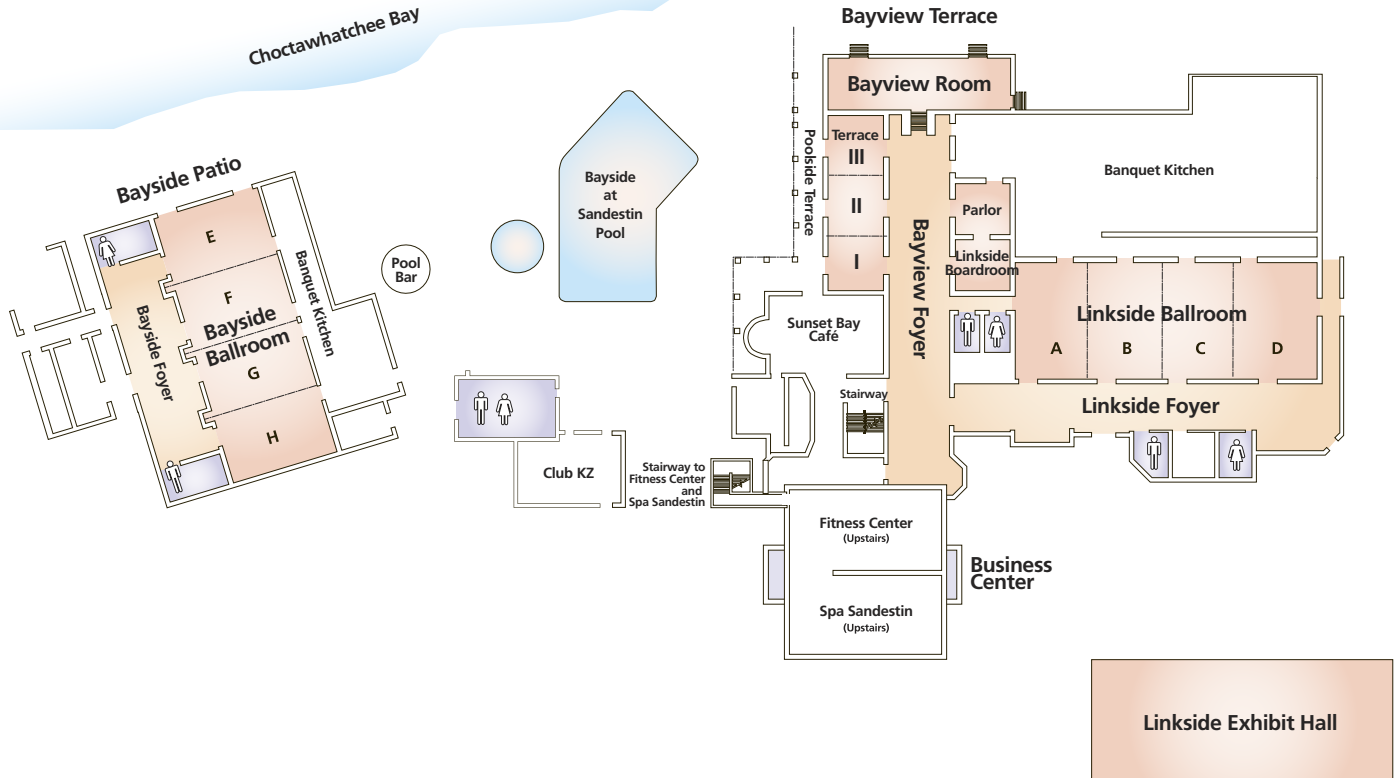

The Linkside Conference Center

Room	Dimensions	Square Feet	Ceiling Height	Theatre Style	Classroom	Banquet	Reception	Hollow Square	U-Shaped	6' x 8' Exhibits
Linkside Ballroom										
Ballroom	120' x 48'	5,760	14'	745	369	470	625	-	-	50
A	28' x 48'	1,344	14'	135	72	90	150	42	-	10
B	28' x 48'	1,344	14'	135	72	90	150	42	-	10
C	28' x 48'	1,344	14'	135	72	90	150	42	-	10
D	35' x 48'	1,680	14'	175	90	110	180	48	-	15
Linkside Foyer	150' x 20'	3,000	-	-	-	-	350	-	-	14
Bayview Conference Rooms										
Terrace I, II & III	70' x 23'	1,610	12'	150	90	100	165	72	-	13
Terrace I	22' x 23'	506	12'	40	24	30	55	24	-	-
Terrace II	24' x 23'	552	12'	40	24	30	60	24	-	-
Terrace III	24' x 23'	552	12'	40	24	30	60	24	-	-
Bayview Foyer	25' x 60'	1,500	-	-	-	-	160	-	-	10
Bayview Room	73' x 23'	1,679	11'	185	90	100	180	66	-	16
Bayview Terrace	-	1,248	-	-	-	-	150	-	-	-
Parlor	23' x 22'	506	11'	-	-	-	20	-	-	-
Boardroom	23' x 22'	506	11'	-	Conference: 12	-	20	-	-	-
Poolside Terrace	-	-	-	-	-	370	700	-	-	-
Bayside Ballroom										
Ballroom	100' x 40'	4,000	16'	475	250	330	420	-	-	30
E	25' x 40'	1,000	16'	110	55	60	100	42	-	-
F	25' x 40'	1,000	16'	110	55	60	100	42	-	-
G	25' x 40'	1,000	16'	110	55	60	100	42	-	-
H	25' x 40'	1,000	16'	110	55	60	100	42	-	-
Bayside Foyer	74' x 16'	1,184	10'	-	-	-	150	-	-	-
Bayside Patio	14' x 75'	1,050	-	-	-	80	125	-	-	-
Linkside Center										
Exhibit Hall	140' x 90'	12,600	20'	1,200	-	950	1,200	-	-	95